

PARKING

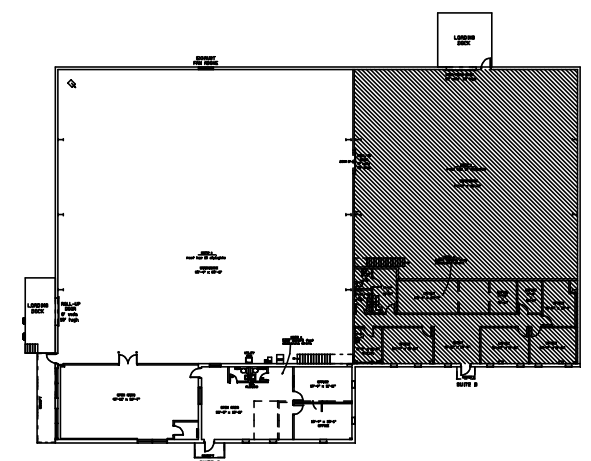

2 BUILDING KEY

1 PARTITION PLAN

PARKING

TO NORTH  
CHURCH LANE

PARKING

HERITAGE  
EQUITIES  
INCORPORATED

Vincent B. Merkle, Jr.

Office: (678) 564-0600  
Toll Free: (877) 841-0605  
Toll Free: (888) 841-9275  
Fax: (678) 564-0603

www.heritage-equities.com

WAREHOUSE BUILDING  
SUITE B

4821 NORTH CHURCH LANE SE  
ATLANTA, GA 30339  
COBB COUNTY

DECEMBER 22, 2020

SCALE: 1/8" = 1'-0"

SQUARE FOOTAGE:  
7,500 +/-



CoyleThompsonJones

6285 BARFIELD RD.  
SUITE 180  
ATLANTA, GEORGIA 30328

(404) 303-6488 PH

(404) 303-6489 FX

www.ctjdesigns.com

psjones@ctjdesigns.com